



Public Works Department – Engineering Division

October 30, 2024

ADDENDUM NO. 3

PROJECT 3080 PITTSBURG PREMIER FIELDS

NOTICE TO BIDDERS:

The following clarifications, amendments, additions and/or deletions as set forth herein shall apply to the above project contract documents and shall be made a part thereof and shall be subject to all the requirements thereof as though originally specified and/or shown. Submitters shall assure themselves that all addendum changes have been incorporated into their proposal.

A. ADDITIONS/DELETIONS

1. **Replace** item 1 of the “NOTICE INVITING BIDS” since the Bid Opening has been **POSTPONED**. – Attachment A

Bid Submission. City of Pittsburg (“City”) will accept sealed bids for its Pittsburg Premier Fields Project (“Project”), by or before **TUESDAY NOVEMBER 5, 2024, at 1:30PM**, at Pittsburg City Hall, located at 65 Civic Avenue, First Floor, Pittsburg, California, at which time the bids will be publicly opened and read aloud.

2. **Replace** the Bid Schedule – Attachment B
3. **Replace** the following Plans/Specifications:
 - a. Spec Section 01 22 00 – UNIT PRICES (all revised items are in red)
 - b. Sheet C-3.4 – Cut and Fill Map (identifying potential area of fill material)

B. CLARIFICATIONS

Please be advised of the following clarifications to the contract documents:

1. Question: Is it the City’s intent that the benching 15 feet back and fill shown in Detail 4, Sheet C5.4 are included only if Bid Item 94 is used, or is this benching and fill to be included as part of the Rough Grade Item?

Answer: The Earthwork, Keyway, benching, piping, subdrains, and cleanout are to be included within Bid Item #94 as shown in the area per Sheet C-4.3 and detail 4/C-5.4.

2. Question: Based on our takeoff the site will require a significant amount of import soil to complete the project. Is there any area adjacent to the site the Contractor

can mine in order to balance the site in-lieu of import fill from an offsite source? This would be a significant savings to the City and reduce truck traffic to and from the site.

Answer: We are seeing a roughly balanced site. If it is determined that there is an earthwork shortage the city will allow the contractor to mine soil within the project site area instead of importing fill from outside source.

3. **Question:** Addendum No. 1 - The response to question No. 6 revised the aggregate base structural section for the asphalt pathway to 4", however Bid Item No. 37 was not adjusted due to this change. Please double check if the quantity needs to be reduced.

Answer: The asphalt pedestrian walkway section has been revised to 2.5" AC / 7" CL AB, see detail below. There will no lime treatment on all pedestrian flatwork. This detail will be added to the conform set.

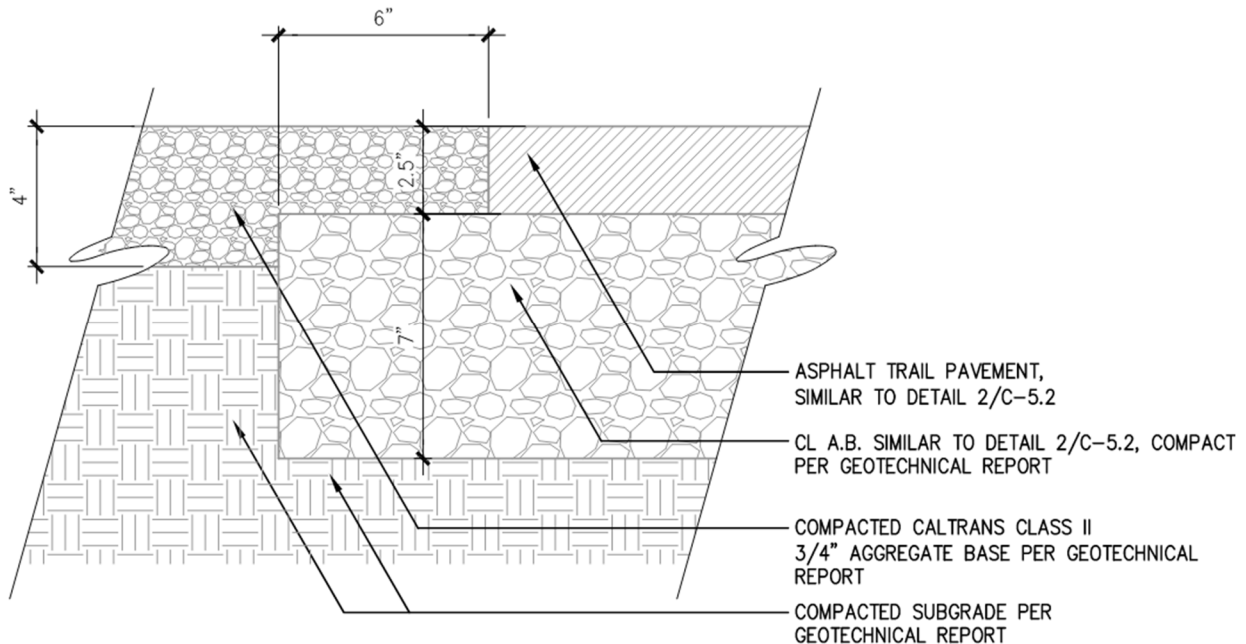

The aggregate base for this asphalt pedestrian walkway is paid under bid item 37.

4. **Question:** Based on our takeoff the aggregate base qty seems to be far less than the bid item quantity stated. However, if we include the base rock for the "Concrete Paving A" areas it nearly matches the bid item quantity. Can the City double check the bid qty to make sure the aggregate base for the concrete paving is not included in this bid item?

Answer: The aggregate base for the concrete paving pathway is not included under bid item 39. The aggregate base for this concrete pathway section is included in bid item 37 which is now 2750 tons, see revised bid schedule.

5. **Question:** Also need clarification from page SP-1.0 . I have a note referring me to page T1.2 for a 4" conduit with 12 strand SMFO. There is no T1.2.

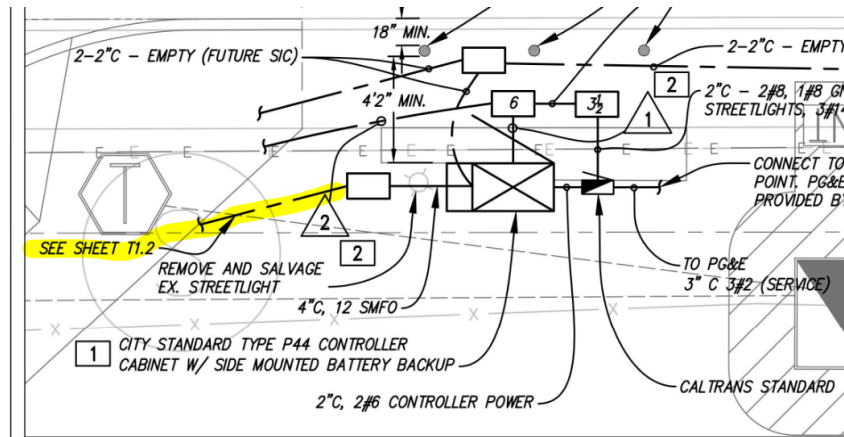

Answer: Provide 2" empty conduit from the signal cabinet to the AT&T vault location on site for future CCTV installation project. Routing to be field verified by Project Engineer during construction. SMFO cable identified in plans is to be ignored and not installed as part of this project

6. **Question:** My takeoff shows discrepancies in quantities

15	Drainage Catch basins (18" SQ)	10	EA	8 ea
20	Storm Drain Piping 6"	319	LF	594 ft
23	Storm Drain Piping 12"	1,002	LF	881 ft
26	Storm Drain Cleanouts	8	EA	17 ea
39	Concrete Paving A	5,437	SF	6,268 sf
41	Curb Ramp	8	EA	7 ea = 1,149 sf
43	Concrete Valley Gutter	1,311	LF	120 LF

Answer: The bid quantities have been confirmed as follows:

- Bid item 15: total 10 (8 catch basins plus 2 storm drain overflows in the bioretention areas equal 10)*
- Bid item 20: Number has been revised to 526 LF, see revised bid schedule*
- Bid item 23: Number has been revised to 879 LF, see revised bid schedule.*

- Bid item 26: The number remains as 8. There are additionally 9 cleanouts that are within the area of work delineated as bid item 94 on page C-4.3 and the 9 AD shall be accounted for in bid item 94.
- Bid item 39: Number has been revised to 6,232 SF, see revised bid schedule
- 41: Number remains as 8 curb ramps
- 43: Number remains as 142 LF

7. Question: Bid Item schedule does not match method of payments.

Q. Bid Item No 18 – Benching subdrain 4" Perforated

18 | Storm Drain Piping 24" | 275 | LF | 275 ft

Answer: Method of payment for Bid Item No. 18 has been updated to reflect the 24" SD pipe, see revised bid schedule attached as Attachment A.

8. Question: Is lime treat required as part of our bid?

Answer: Yes, and it will only be applicable to the asphalt parking lot. The new parking lot section will be 3.5" AC/4" CL AB/12" lime treatment, see revised section below.

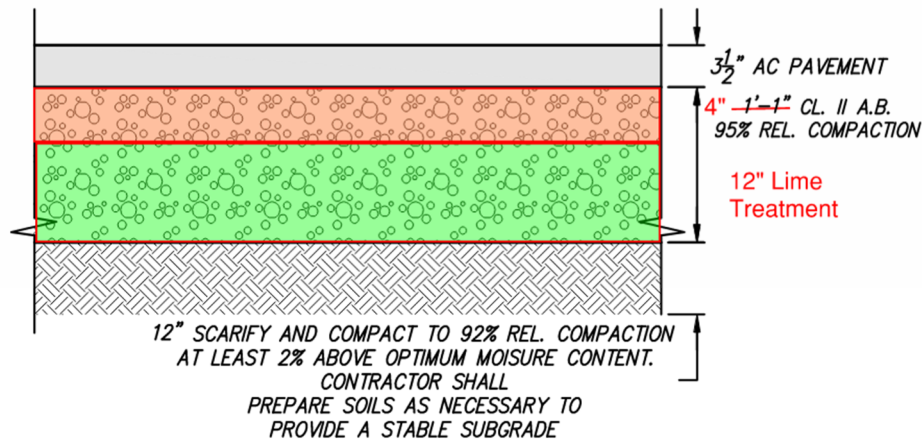

ASPHALT PAVEMENT

1"=1'

12

Contractor shall follow lime treatment applications and recommendations as outlined in the geotechnical report sections 11.1.3 and 11.6.1 for asphalt pavement. Lime treatment shall be paid under earthwork, Bid Item 10. Refer to the spec section 01 22 00 - unit price schedule for method of payment language.

As a result, Bid item 10 earthwork has increased due to the reduction in AB. Refer to sheet C3.4 where potential area of fill material has been identified. We are still expecting the site to be balanced, and we will provide revised grading sheets as part of the conform set to show the additional earthwork limits. As a result of lime treatment the following bid items have been revised:

- Bid item 10 Earthwork – 55,000 CY*
- Bid item 37 AB course – 2,750 CY (reduction due to the Lime Treatment)*
- Bid item 48 Hydroseeded 32,000 SF – this area has increased to encompass the additional earthwork limits shown on the revised sheet C3.4.*

- 9.** *If lime treat is required, to what depth, and what are the limits (assumed all asphalt, concrete and gravel road sections)?*

Answer: 12" lime treatment shall be applied to the entire AC parking lot. The new asphalt pavement section is (3-1/2" AC / 4" CL II A.B / 12" lime treatment

- 10.** *In Addendum #1, Question #32, the plan is to start this project in December which is right in the middle of winter. This site has clayey soils which when get too wet cannot be compacted and the site becomes unsafe for heavy equipment as they clayey soils become slippery. What is the City's plan if we encounter a typical winter? If it gets too wet, will we just pause the job until it is dry enough?*

Answer: If we encounter a heavy winter storm the city will evaluate the situation and if needed, we will pause the work until weather conditions permit the continuation of construction.

- 11.** *I find no description for the pay item for bid item #18 SD Piping 24". Is the traffic control and AC patch required for the bid item included in the bid item or their respective bid items (AC, Traffic Control)?*

Answer: Payment description for bid item 18 has been added to section R in the Spec Section 01 22 00 – UNIT PRICES, see attached. Traffic control for this item is paid under bid item 3. AC patching is included in the bid item 18 under basis of payment bullet #3, see snippet below.

Includes sawcut, excavation, all utility trenching work as specified in Section 31 23 16 – Utility Trenching, protecting the excavation in compliance with Cal/OHSA, pipe and fittings, bedding, backfill, and surface restoration including AC patch.

- 12.** *For bid item #36, Asphalt, the pay item indicates 3" of asphalt, whereas the detail calls out for 3-1/2" of asphalt. Can you please confirm which is it.*

Answer: The correct section is 3-1/2" of asphalt. This has been updated in the pay item of spec section 01 22 00 – UNIT PRICES.

BIDDERS MUST SIGN AND ATTACH one (1) copy of this addendum document to the proposal as acknowledgment of receipt of these instructions and that said addendum was properly evaluated in the proposal.

ANY PROPOSAL NOT IN COMPLIANCE WITH THIS ADDENDUM MAY BE REJECTED.

Issued: 10/30/24



Senior Engineer

ADDENDUM NO. 3, PROJECT 3080 PITTSBURG PREMIER FIELDS is hereby acknowledged and was considered in this Project Proposal.

Bidder's Signature

Date

Firm Name

Mailing Address

City/State/Zip+4

Notice Inviting Bids

1. **Bid Submission.** The City of Pittsburg (“City”) will accept sealed bids for its Pittsburg Premier Fields Project (“Project”), by or before **November 5, 2024**, at 1:30 p.m., at its Pittsburg City Hall office, located at 65 Civic Avenue, Pittsburg, California, at which time the bids will be publicly opened and read aloud.
2. **Project Information.**
 - 2.1 **Location and Description.** The Project is located at 2225 John Henry Johnson Parkway and is described as follows: The project construct one multi-purpose field, parking lot, traffic signal control intersection, and water quality features. The Project will also include utilities, field lighting, landscaping and irrigation, various site furnishings, paved and unpaved walkways, trails circling the facility, a pick-up and drop off area, and all other items of work as shown on the Plans.
 - 2.2 **Time for Final Completion.** The Project must be fully completed within 240 calendar days from the start date set forth in the Notice to Proceed. City anticipates that the Work will begin on or about December 30, 2024, but the anticipated start date is provided solely for convenience and is neither certain nor binding.
 - 2.3 **Estimated Cost.** The estimated construction cost is \$5,365,000.
3. **License and Registration Requirements.**
 - 3.1 **License.** This Project requires a valid California contractor’s license for the following classification(s): Class A General Engineering.
 - 3.2 **DIR Registration.** City may not accept a Bid Proposal from or enter into the Contract with a bidder, without proof that the bidder is registered with the California Department of Industrial Relations (“DIR”) to perform public work pursuant to Labor Code § 1725.5, subject to limited legal exceptions.
4. **Contract Documents.** The plans, specifications, bid forms and contract documents for the Project, and any addenda thereto (“Contract Documents”) may be downloaded from City’s website located at: <https://www.pittsburgca.gov/business/current-bidding-opportunities>. A printed copy of the Contract Documents is not available.
5. **Bid Security.** The Bid Proposal must be accompanied by bid security of ten percent of the maximum bid amount, in the form of a cashier’s or certified check made payable to City, or a bid bond executed by a surety licensed to do business in the State of California on the Bid Bond form included with the Contract Documents. The bid security must guarantee that within ten days after City issues the Notice of Potential Award, the successful bidder will execute the Contract and submit the payment and performance bonds, insurance certificates and endorsements, valid Certificates of Reported Compliance as required under the California Air Resources Board’s In-Use Off-Road Diesel-Fueled Fleets Regulation (13 CCR § 2449 et seq.) (“Off-Road Regulation”), if applicable, and any other submittals required by the Contract Documents and as specified in the Notice of Potential Award.
6. **Prevailing Wage Requirements.**
 - 6.1 **General.** Pursuant to California Labor Code § 1720 et seq., this Project is subject to the prevailing wage requirements applicable to the locality in which the Work is to be performed for each craft, classification or type of worker needed to perform

the Work, including employer payments for health and welfare, pension, vacation, apprenticeship and similar purposes.

- 6.2 Rates.** The prevailing rates are on file with the City and are available online at <http://www.dir.ca.gov/DLSR>. Each Contractor and Subcontractor must pay no less than the specified rates to all workers employed to work on the Project. The schedule of per diem wages is based upon a working day of eight hours. The rate for holiday and overtime work must be at least time and one-half.
- 6.3 Compliance.** The Contract will be subject to compliance monitoring and enforcement by the DIR, under Labor Code § 1771.4.
- 7. Bidder's Conference.** A bidder's conference will be held on October 24, 2024, at 2:00 p.m. at the following location: City Hall, located at 65 Civic Avenue, Pittsburg, CA to acquaint all prospective bidders with the Contract Documents and the Worksite. The bidders' conference is not mandatory.
- 8. Performance and Payment Bonds.** The successful bidder will be required to provide performance and payment bonds, each for 100% of the Contract Price, as further specified in the Contract Documents.
- 9. Substitution of Securities.** Substitution of appropriate securities in lieu of retention amounts from progress payments is permitted under Public Contract Code § 22300.
- 10. Subcontractor List.** Each Subcontractor must be registered with the DIR to perform work on public projects. Each bidder must submit a completed Subcontractor List form with its Bid Proposal, including the name, location of the place of business, California contractor license number, DIR registration number, and percentage of the Work to be performed (based on the base bid price) for each Subcontractor that will perform Work or service or fabricate or install Work for the prime contractor in excess of one-half of 1% of the bid price, using the Subcontractor List form included with the Contract Documents.
- 11. Instructions to Bidders.** All bidders should carefully review the Instructions to Bidders for more detailed information before submitting a Bid Proposal. The definitions provided in Article 1 of the General Conditions apply to all of the Contract Documents, as defined therein, including this Notice Inviting Bids.

By: _____



Date: 10/9/2024

John Samuelson, Public Works Director/City Engineer

Publication Date: October 9, 2024

END OF NOTICE INVITING BIDS

Bid Schedule

This Bid Schedule must be completed in ink and included with the sealed Bid Proposal. Pricing must be provided for each Bid Item as indicated. Items marked "(SW)" are Specialty Work that must be performed by a qualified Subcontractor. The lump sum or unit cost for each item must be inclusive of all costs, whether direct or indirect, including profit and overhead. The sum of all amounts entered in the "Extended Total Amount" column must be identical to the Base Bid price entered in Section 1 of the Bid Proposal form.

AL = Allowance CF = Cubic Feet CY = Cubic Yard EA = Each LB = Pounds
 LF = Linear Foot LS = Lump Sum SF = Square Feet TON = Ton (2000 lbs)

BID ITEM NO.	ITEM DESCRIPTION	EST. QTY.	UNIT	UNIT COST	EXTENDED TOTAL AMOUNT
1	Bonding & Mobilization	1	LS		
2	Construction Surveying	1	LS		
3	Traffic Control	1	LS		
4	SWPPP	1	LS		
5	QSP Services	1	LS		
6	Clearing & Grubbing	1	LS		
7	Demolition	1	LS		
8	Tree Protection	1	LS		
9	Tree and Stump Removal	28	EA		
10	Earthwork - Rough Grade	55,000	CY		
11	Fine Grading	261,000	SF		
12	Bioretention Soil Mix (BSM)	470	CY		
13	Traffic Signalization	1	LS		
14	Drainage Catch basins (12" SQ)	4	EA		
15	Drainage Catch basins (18" SQ)	10	EA		
16	Storm Drain Area Drain	2	EA		
17	Storm Drain Manhole	5	EA		
18	Storm Drain Piping 24"	275	LF		
19	Storm Drain Piping 6" Perforated	311	LF		
20	Storm Drain Piping 6"	526	LF		
21	Storm Drain Piping 8"	241	LF		
22	Storm Drain Piping 10"	215	LF		
23	Storm Drain Piping 12"	879	LF		
24	Storm Drain Piping 15"	424	LF		

BID ITEM NO.	ITEM DESCRIPTION	EST. QTY.	UNIT	UNIT COST	EXTENDED TOTAL AMOUNT
25	Storm Drain Connection	2	EA		
26	Storm Drain Cleanouts	8	EA		
27	Sanitary Sewer Cleanouts	2	EA		
28	Sanitary Sewer Piping 4"	386	LF		
29	Sanitary Sewer Connection	1	EA		
30	Potable Water Line	90	LF		
31	Fire Water Line	45	LF		
32	Water Valve	3	EA		
33	Water Line Tie In	3	EA		
34	Backflow Preventor	1	EA		
35	Bioretention Drain Rock	392	CY		
36	Asphalt	1,980	TONS		
37	Aggregate Base Course	2,750	TONS		
38	Concrete Curb	3,900	LF		
39	Concrete Paving A	6,232	SF		
40	Landscape Wall	40	LF		
41	Curb Ramp	8	EA		
42	Traffic Signage	1	LS		
43	Concrete Valley Gutter	142	LF		
44	Wheel Stops	8	EA		
45	Striping Removal	1	LS		
46	Striping	1	LS		
47	Stairs & Handrails	1	LS		
48	Hydroseed	51,900	SF		
49	Shrub - 1 Gal	1,489	EA		
50	Sod	66,095	SF		
51	Trees - 24" Box	30	EA		
52	Trees - 15 Gallon	28	EA		
53	Landscape Soil Preparation	146,500	SF		
54	Root Barrier	768	LF		
55	Mulch	19,100	SF		
56	Plant Establishment Period	146,500	SF		
57	Irrigation Controller	1	EA		

BID ITEM NO.	ITEM DESCRIPTION	EST. QTY.	UNIT	UNIT COST	EXTENDED TOTAL AMOUNT
58	Irrigation Rotors	48	EA		
59	Irrigation Bubblers	465	EA		
60	Flush Valve	18	EA		
61	Irrigation Tree Bubblers	116	EA		
62	Irrigation Lateral Line	8,700	LF		
63	Irrigation Conduit	10	LF		
64	Irrigation Gate Valves	5	EA		
65	Irrigation Drip	13,400	SF		
66	Irrigation Sleeves	1,075	LF		
67	Irrigation Main line 2"-3"	1,250	LF		
68	Irrigation Main line 4" & 6"	725	LF		
69	Irrigation Master Valve and Flow Sensor	1	EA		
70	Irrigation Low voltage wire	1	LS		
71	Irrigation Quick Coupler Valves	9	EA		
72	Irrigation Remote Control Valves	34	EA		
73	Irrigation Angle Valves	4	EA		
74	Irrigation Restoration	1	LS		
75	Boulders	2	EA		
76	Fence A (6')	155	LF		
77	Fence B (8')	135	LF		
78	Gate A	1	EA		
79	Gate B	2	EA		
80	Gate C	2	EA		
81	Header	455	LF		
82	Soccer Goals	2	EA		
83	Park Sign	1	EA		
84	Relocated Park Sign	1	EA		
85	Site/Area Post top Luminaire	27	EA		
86	Lighting control system	1	LS		
87	Electrical Main Switchboard	1	LS		
88	Distribution Power	1	LS		
89	Transformers	1	LS		

BID ITEM NO.	ITEM DESCRIPTION	EST. QTY.	UNIT	UNIT COST	EXTENDED TOTAL AMOUNT
90	Conduit and Conductors (Electrical and Lighting)	1	LS		
91	Conduit (Technology, 2-inch, 4-inch)	960	LF		
92	Handholes (Pullbox)	27	EA		
93	Underground vaults	3	EA		
94	Fill slope, Keyway and Subdrain	1	LS		

* Final Pay Quantity

TOTAL BASE BID: Items 1 through 94 inclusive
 \$ _____

Note: The amount entered as the "Total Base Bid" should be identical to the Base Bid amount entered in Section 1 of the Bid Proposal form.

BIDDER NAME:

END OF BID SCHEDULE

SECTION 01 22 00 –UNIT PRICES

PART 1 - GENERAL

1.1 SUMMARY

- A. This Section specifies procedures and requirements for measurement and payment for unit price items listed on the Bid Form for each unit of work described herein.
- B. Refer to Division 00 General Conditions and Division 00 Article 8 – Payment for related requirements pertaining to change orders, payments and unit prices.
- C. Prices:
 - 1. In addition to Base Bid, Bidder shall quote unit prices, in appropriate spaces on Bid Form for each unit of work as described herein. Change Orders will be based on unit prices quoted on Bid Form for applicable work.
 - 2. In event any unit price quoted appears to compare unfavorably with currently established prices for type of work, City reserves the right to require quoted price to be substantiated or adjusted prior to execution of contract.
 - 3. Unit prices listed on the Bid Form for the following items shall constitute full and complete compensation for each unit, and shall include cost of temporary and administrative work, permits, bonds, insurance, sales taxes, overhead, profit and every other expense, direct or indirect, incident to accomplishment of work under each item.

PART 2 - PRODUCTS

NOT USED

PART 3 - EXECUTION

3.1 MEASUREMENT

- A. Measurement of quantities for payment will be made or determined by City's Inspector.
 - 1. Volume of any material shall be based on information included with Drawings and additional measurements obtained by Inspector, or by combination of such information, or in a manner which, in the opinion of the Inspector, is best suited to obtain necessary accuracy.
 - 2. In case of unit prices based upon weight measurement, certified weight tickets shall be supplied at time of delivery of materials.

3. Excess materials delivered to the site, but not incorporated in the work, will not be paid for.

3.2 UNIT PRICE ITEMS

A. Bid Item No.1 – Bonding & Mobilization

1. All work involved in Mobilization will be measured by Lump Sum, unless otherwise specified in the Contract Documents.
2. Payment for “Mobilization” shall constitute but not limited to full compensation for all such work. Payment for mobilization will be made in the form of a Lump Sum, non-prorate-able payment, no part of which will be approved for payment under the Contract until all mobilization items listed herein have been completed as specified. The scope of the work included under this bid item shall include the obtaining of all bonds, insurance, and permits; moving onto the project site, inclusive of any staging areas, all equipment, personnel, and permanent and temporary facilities as required for the proper performance and completion of the Work. Mobilization shall include but not be limited to the following principal items:
 - a. Arrangement with and payment for project staging areas with necessary responsible parties, inclusive of all necessary site investigation, reporting, permitting, traffic control, temporary fencing, crushed rock surfacing (if required), and all other improvements upon the land and work associated with the establishment and ongoing maintenance of staging areas.
 - b. Moving on to the project site of all Contractor's equipment, personnel, and temporary and permanent facilities required for the project.
 - c. Installing a minimum of one (1) project identification sign, including all necessary work to manufacture, label, place, maintain, remove, and dispose of such identification signs and all labor, materials, tools, and equipment in performing the work required per the Contract Documents.
 - d. Providing on site sanitary facilities and potable water facilities.
 - e. Furnishing, installing, and maintaining all storage buildings or sheds required for temporary storage of products, equipment, or materials that have not yet been installed in the Work. All such storage shall meet manufacturer's specified storage requirements, and the specific provisions of the specifications, including temperature and humidity control, if recommended by the manufacturer, and for all security.
 - f. Any work, coordination, hardware/software, Internet, and related technical or process-based activities associated with the project's web-based document management system.
 - g. Obtaining and paying for all required bonds, insurance, permits and licenses.
 - h. Posting all OSHA required notices and establishment of safety programs.
 - i. Submittal of required Construction Schedule.

- j. Conducting a pre-construction photographic survey of construction access, existing areas to remain, and all work areas.
 3. Note: Contractor is advised that no payment for the "Mobilization" bid item will be made unless the construction schedule and traffic control plan have been submitted and accepted by the Engineer.
 4. In addition to the requirements specified above, all submittals shall conform to the applicable requirements of Section City Standard Section 1-14, Shop Drawings and Product Data Submittals for submittal requirements and procedures.
 5. No payment for any of the listed mobilization and demobilization work items will be made until all of the listed items have been completed, as specified, to the satisfaction of the Engineer.
- B. Bid Item No 2 – Construction Surveying
1. Basis of Measurement: By Lump Sum as specified in the bid form complete in place, unless otherwise specified in the Contract Documents.
 2. Basis of Payment: Shall include but not limited to full compensation for furnishing all labor, materials, tools, equipment, and incidentals and for doing all the work involved in land survey and staking, including control surveying, staking calculations, calculating grades for all hardscape, pipes grading and all other items listed in the specifications, submitting staking calculations in AutoCAD to the engineer for all items listed in the specifications, field surveying/staking, topo shots on curb forms prior to pouring concrete, protecting survey monuments, referencing survey monuments, pothole survey, quality control survey and as-built GPS surveys complete in place as shown on the plans, as specified in the Standard Specifications and these Special Provisions, and as directed by the Engineer.
- C. Bid Item No 3 – Traffic Control
1. Basis of Measurement: By Lump Sum as specified in the bid form complete in place, unless otherwise specified in the Contract Documents.
 2. Basis of Payment: Shall include but not limited to full compensation for furnishing all labor, materials, tools, equipment, and incidentals and for doing all the work involved in providing Traffic Control and Pedestrian Access Plans for each stage of construction, including placing, removing, storing, maintaining, moving to new locations, replacing and disposing of the components of the traffic control system (excluding construction area signs), installing AC paving as required for all traffic control and handling, temporary traffic striping and markers as required and supervision, furnishing Flaggers as necessary to give adequate warning to traffic or to the public of any dangerous conditions to be encountered, complete in place, including coordinating for traffic control and maintaining of existing, temporary and proposed bus stops; providing Temporary Railings (Type K) and crash cushions, and all other work described in this section, as shown on the plans, as specified in the Standard Specifications and these Special Provisions, and as directed by the Engineer.

Full compensation for providing pedestrian facilities shall be considered as included in the contract Lump Sum price paid for Traffic Control System & Construction Area Signs and no additional compensation will be allowed, therefore.

Full Compensation for Flagging Costs shall be considered as included in the contract Lump Sum price paid for Traffic Control System & Construction Area Signs and no additional compensation will be allowed, therefore.

Full Compensation for doing all the work involved in furnishing, installing, maintaining Construction Area Signs and for removing Construction Area Signs when no longer required, including pedestrian access signs shall be considered as included in the contract Lump Sum price paid for Traffic Control System & Construction Area Signs and no additional compensation will be allowed. Therefore.

Full Compensation for temporary K-Railing and crash cushions including furnishing, placing, maintaining, repairing, replacing, and removing the temporary railing, including excavation and backfill, any flagging costs, drilling holes and bonding threaded rods or dowels when required, removing threaded rods or dowels and filling the drilled holes with mortar and moving and replacing removable panels as required to new locations of K-Rail shall be considered as included in the contract Lump Sum price paid for Traffic Control System & Construction Area Signs and no additional compensation will be allowed, therefore.

3. Includes public notice to police, fire, school, etc.

D. Bid Item No 4 – SWPPP (Storm Water Pollution Prevention Plan)

1. Basis of Measurement: By Lump Sum as specified in the bid form complete in place, unless otherwise specified in the Contract Documents.
2. Basis of Measurement: Shall include but not limited to full compensation for furnishing all labor, materials, tools, equipment, and incidentals and for doing all the work involved in furnishing, installing, maintaining, relocating and removing when no longer required best management practices, erosion and sedimentation control measures such as temporary fiber rolls, temporary silt fences, hydroseeding during construction, maintenance of construction entrance, protecting adjacent waterways, temporary drainage inlet protection, maintaining construction entrance/exit, temporary concrete washout, stockpile cover, protection of storage and recyclable materials, portable toilets, maintaining drainage patterns to allow flows to the low points, as shown on the Plans, as specified in the Standard Specifications, these Special Provisions, and as directed by the Engineer.
3. All temporary and permanent storm water pollution prevention facilities, equipment, and materials as required by or as necessary to comply with the SWPPP/WPCP as described in the current California Stormwater Quality Association (CASQA) BMP handbook.
4. Temporary erosion and sediment control work shall consist of applying erosion control materials to embankment slopes, excavation slopes and

other areas designated on the plans, installing silt fence, inlet protection, gravel bags, headwall protection and stabilized construction entrance ways, or other measures as specified in the project SWPPP/WPCP or necessary for compliance with the CGP.

E. Bid Item No 5 – QSP Services

1. Basis of Measurement: By Lump Sum as specified in the bid form complete in place, unless otherwise specified in the Contract Documents.
2. Basis of Payment: Shall include but not limited to full compensation for furnishing all labor, materials, tools, equipment, and incidentals, and for doing all work involved in QSP Services including but not limited to complying with the project SWPPP as shown on the plans, as specified and as directed by the Engineer.

F. Bid Item No 6 – Clearing & Grubbing

1. Basis of Measurement: By Lump Sum as specified in the bid form complete in place, unless otherwise specified in the Contract Documents.
2. Basis of Payment: Shall include but not limited to full compensation for furnishing all labor, materials, tools, equipment, and incidentals, and for doing all work involved in clearing and grubbing including but not limited to removal of organics, off haul, trucking, testing, and disposal as shown on the plans, as specified and as directed by the Engineer, including the removal and disposal of all the resulting material.

G. Bid Item No 7 – Demolition

1. Basis of Measurement: By Lump Sum as specified in the bid form complete in place, unless otherwise specified in the Contract Documents.
2. Basis of Payment: Shall include but not limited to full compensation for furnishing all labor, materials, tools, equipment and incidentals for doing all work involved in Demolition, including obtaining demolition permits, permit fees, fence removal and disposal, sawcut, remove asphalt and concrete paving and base to design subgrade, remove foundation and base; terminating and removing utilities to be demolished and other items of work as specified in the plans, Standard Specification and the Technical Specifications, and as directed by the Engineer.
3. Miscellaneous demolition includes removal, off-haul, and legal disposal of incidental items included in the scope as specified in the plans, Standard Specification and the Technical Specifications, and as directed by the Engineer.

H. Bid Item No 8 – Tree Protection

1. Basis of Measurement: By Lump Sum as specified in the bid form complete in place, unless otherwise specified in the Contract Documents.

2. Basis of Payment: Shall include but not limited to full compensation for furnishing all labor, materials, tools, equipment, and incidentals, and for doing all work involved in tree protection as shown on the plans, as specified and as directed by the Engineer, including the removal and disposal of all the resulting material.
 3. Tree Protection includes standard construction fencing and posts. Includes review and approval by the Engineer.
- I. Bid Item No 9 – Tree and Stump Removal
1. Basis of Measurement: By Each as specified in the bid form complete in place, unless otherwise specified in the Contract Documents.
 2. Basis of Payment: Shall include but not limited to full compensation for furnishing all labor, materials, tools, equipment, and incidentals, and for doing all work involved in tree and stump removal as shown on the plans, as specified, and as directed by the Engineer, including the removal and disposal of all the resulting material.
 3. This bid item is for the removal and disposal of all trees with a trunk diameter size of six inches or greater including the root balls. Tree and stump removal includes review and approval by the Engineer.
- J. Bid Item No 10 – Earthwork – Rough Grade
1. Basis of Measurement: By Cubic Yard as specified in the bid form complete in place, unless otherwise specified in the Contract Documents.
 2. Basis of Payment: Shall include but not limited to excavating existing subsoil, verifying if existing subsoil meets the engineered fill requirements, supplying engineered fill, materials, **installation of 12" lime treatment as outlined in the geotechnical report**, stockpiling, maintaining, moving, placing, rough grading, and compacting of engineered fills as shown on the plans, as specified, and as directed by the Engineer.
- K. Bid Item No 11 –Fine Grading
1. Basis of Measurement: By Square Feet as specified in the bid form complete in place, unless otherwise specified in the Contract Documents.
 2. Basis of Payment: Shall include but not limited to full compensation for furnishing all labor, materials, tools, equipment, and incidentals, and for doing all work involved in Fine Grading as shown on the plans, as specified, and as directed by the Engineer.
- L. Bid Item No 12 – Bioretention Soil Mix (BSM)
1. Basis of Measurement: By Cubic Yard as specified in the bid form complete in place, unless otherwise specified in the Contract Documents.
 2. Basis of Payment: Shall include but not limited to full compensation for furnishing all labor, materials, bioretention soil mix, soil testing report, tools, equipment, and incidentals, and for doing all work involved in Bioretention Soil Mix as shown on the plans, as specified, and as directed by the Engineer.

M. Bid Item No 13 – Traffic Signalization

1. Basis of Measurement: By Lump Sum as specified in the bid form complete in place, unless otherwise specified in the Contract Documents.
2. Basis of Payment: Shall include but not limited to full compensation for furnishing labor, materials, tools, equipment and incidentals, to install traffic signals including, but not limited to, the installation of signal poles, traffic signal controller, cabinet and cabinet equipment, battery backup system and equipment, input/output files, detector handholds, signal detection system as indicated on Plan, push buttons and posts, signal heads, conduits, all associated wiring and conductors, pull boxes, sign installations, internally illuminated street name signs, mounting equipment, foundations, trenching/backfill, and all other necessary materials not otherwise included in separate items, as indicated in the Plans, and these Technical Provisions, in order to provide a fully functioning traffic signal system as directed by the Engineer, as well as all testing as required and as directed by the Engineer, as well as coordination with PG&E to provide service connection to the cabinet, and no additional compensation shall be allowed.

N. Bid Item No 14 – Drainage catch basins (12" SQ)

Bid Item No. 15 - Drainage catch basins (18" SQ)

1. Basis of Measurement: By Each as specified in the bid form complete in place, unless otherwise specified in the Contract Documents. Structure bedding and backfill are incidental to the bid item most closely related to and no separate compensation allowed therefore.
2. Basis of Payment: Shall include but not limited to excavating, all utility trenching work as specified in Section 31 23 16 – Utility Trenching, concrete foundation slab, concrete structure sections, bedding, backfill, concrete masonry structure construction, transition to cover frame, cover frame and cover to indicated design depth, forming, sealing pipe inlets and outlets and air testing of structures as required by the contract documents and as directed by the Engineer.

O. Bid Item No 16 – Storm Drain Landscape Area Drain

1. Basis of Measurement: By Each as specified in the bid form complete in place, unless otherwise specified in the Contract Documents. Structure bedding and backfill are incidental to the bid item most closely related to and no separate compensation allowed therefor.
2. Basis of Payment: Shall include but not limited to excavating, all utility trenching work as specified in Section 31 23 16 – Utility Trenching, concrete foundation slab, concrete structure sections, bedding, backfill, concrete masonry structure construction, transition to cover frame, cover frame and cover to indicated design depth, forming, sealing pipe inlets and outlets and air testing of structures as required by the contract documents and as directed by the Engineer

P. Bid Item No 17 – Storm Drain Manhole

1. Basis of Measurement: By Each as specified in the bid form complete in place, unless otherwise specified in the Contract Documents. Structure bedding and backfill are incidental to the bid item most closely related to and no separate compensation allowed therefore.
2. Basis of Payment: Shall include but not limited to excavating, all utility trenching work as specified in Section 31 23 16 – Utility Trenching, concrete foundation slab, concrete structure sections, bedding, backfill, concrete masonry structure construction, transition to cover frame, cover frame and cover to indicated design depth, forming, sealing pipe inlets and outlets and air testing of structures as required by the contract documents and as directed by the Engineer.

Q. Bid Item No. 19 – Storm Drain Piping 6" Perforated

1. Basis of Measurement: By Linear Foot as specified in the bid form measured from edge of structure to edge of structure for various pipe materials and various sizes irrespective of the depth of pipes, complete in place, unless otherwise specified in the Contract Documents.
2. Basis of Payment: Shall include but not limited to full compensation for furnishing all labor, materials, tools, equipment, and incidentals, and for doing all the work involved in furnishing and installing Storm Drainage Piping, complete in place including bends, elbows or other pipe fittings, saw cut, excavating to required elevations, all utility trenching work as specified in Section 31 23 16 – Utility Trenching, protecting the excavation in compliance with Cal/OSHA, removing excavated materials, dewatering, bedding, cradles, backfill and backfill material, pipe installation with warning tape, restoration and disposing of materials outside the Right-of-Way and connections to existing or new storm drainage mains and manholes as required by the contract documents and as directed by the Engineer.

R. Bid Item No 18 – Storm Drain Piping 24"

Bid Item No 20 – Storm Drain Piping 6"

Bid Item No 21 – Storm Drain Piping 8"

Bid Item No 22 – Storm Drain Piping 10"

Bid Item No 23 – Storm Drain Piping 12"

Bid Item No 24– Storm Drain Piping 15"

1. Basis of Measurement: By Linear Foot for various sizes of storm drain piping as specified in the bid form measured from edge of structure to edge of structure for various pipe materials and various sizes irrespective of the depth of pipes, complete in place, unless otherwise specified in the Contract Documents.
2. Basis of Payment: Shall include but not limited to full compensation for furnishing all labor, materials, tools, equipment, and incidentals, and for doing all the work involved in furnishing and installing Storm Drainage Piping, complete in place including bends, elbows or other pipe fittings, saw cut, protecting the excavation in compliance with Cal/OSHA, excavating to required elevations, all utility trenching work as specified in Section 31 23

16 – Utility Trenching, removing excavated materials, dewatering, bedding, cradles, backfill and backfill material, pipe installation with warning tape, restoration and disposing of materials outside the Right-of-Way and connections to existing or new storm drainage mains and manholes as required by the contract documents and as directed by the Engineer.

3. Includes sawcut, excavation, all utility trenching work as specified in Section 31 23 16 – Utility Trenching, protecting the excavation in compliance with Cal/OHSA, pipe and fittings, bedding, backfill, and surface restoration including AC patch.

S. Bid Item No 25 – Storm Drain Connection

1. Basis of Measurement: By Each as specified in the bid form complete in place, unless otherwise specified in the Contract Documents.
2. Basis of Payment: Storm Drain Connection costs shall be paid for at the contract per the number of Public Main Storm Drain Connection, which includes full compensation for furnishing all labor, interception of the existing 24” Storm Drain line and install a new Storm Drain Manhole, materials, tools, equipment, and incidentals, and for doing all work involved in Storm Drain Connection as shown on the plans, as specified and as directed by the Engineer, including the removal and disposal of all the resulting material.
3. Includes City staff inspection and Testing.

T. Bid Item No 26 – Storm Drain Cleanouts

1. Basis of Measurement: By Each as specified in the bid form complete in place, unless otherwise specified in the Contract Documents.
2. Basis of Payment: Shall include but not limited to sawcut, excavation, including all utility trenching work as specified in Section 31 23 16 – Utility Trenching, traffic-rated box, riser, accessories, concrete collar, tests, backfill and surface restoration as required by the contract documents and as directed by the Engineer.

U. Bid Item No 27 – Sanitary Sewer Cleanouts

1. Basis of Measurement: By Each as specified in the bid form complete in place, unless otherwise specified in the Contract Documents.
2. Basis of Payment: Shall include full compensation for furnishing all labor, materials, tools, equipment, and incidentals, and for doing all the work involved in furnishing and installing Sanitary Sewer Cleanouts, complete in place including all utility trenching work as specified in Section 31 23 16 – Utility Trenching, riser pipe installation, pipe connection, fittings, aggregate base for subgrade, compaction, restoration of trench, testing, CCTV inspections and disposing of materials outside the Right-of-Way and connection to existing or new sewer mains as required by the contract documents and as directed by the Engineer.

V. Bid Item No 28 – Sanitary Sewer Piping 4”

1. Basis of Measurement: By Linear Foot as specified in the bid form , measured along the top centerline of the pipe from inside of a structure to structure, complete in place, unless otherwise specified in the Contract Documents.
2. Basis of Payment: Shall include full compensation for furnishing all labor, materials, tools, equipment, and incidentals, and for doing all the work involved in furnishing and installing Sanitary Sewer Pipes, complete in place including all utility trenching work as specified in Section 31 23 16 – Utility Trenching, protecting the excavation in compliance with Cal/OSHA, pipe installation with warning tape, pipe connection, connection to manholes, fittings, aggregate base for subgrade, compaction, restoration of T-trench, AC patch, testing, CCTV inspections and disposing of materials outside the Right-of-Way and connection to existing or new sewer mains and manholes as required by the contract documents and as directed by the Engineer.

W. Bid Item No 29 – Sanitary Sewer Connection

1. Basis of Measurement: By Each as specified in the bid form complete in place, unless otherwise specified in the Contract Documents.
2. Basis of Payment: Shall include full compensation for furnishing all labor, materials, tools, equipment, and incidentals, and for doing all the work involved in furnishing and installing Sanitary Sewer Connection by intercepting the existing 8” SS and install a new Sanitary Sewer Manhole, complete in place including all utility trenching work as specified in Section 31 23 16 – Utility Trenching, riser pipe installation, pipe connection, fittings, aggregate base for subgrade, compaction, restoration of trench, AC patch, testing, CCTV inspections and disposing of materials outside the Right-of-Way and connection to existing or new sewer mains as required by the contract documents and as directed by the Engineer.

X. Bid Item No 30 – Potable Water Line

Bid Item No. 31 – Fire Water Line

1. Basis of Measurement: By Linear Foot as specified in the bid form complete in place, unless otherwise specified in the Contract Documents.
2. Basis of Payment: Shall include but not limited to hand-trimming, sawcut, excavation, all utility trenching work as specified in Section 31 23 16 – Utility Trenching, protecting the excavation in compliance with Cal/OSHA, pipe and fittings, bedding, backfill, surface restoration, AC patch, concrete thrust restraints, mechanical joints, warning tape, tracer wire, polyethylene fittings, connection and stub for future service, pressure pipeline testing, flushing, disinfection and connection and tie into municipal utility water source as required by the contract documents and as directed by the Engineer.

Y. Bid Item No 32 – Water Valve

1. Basis of Measurement: By Each as specified in the bid form complete in place, unless otherwise specified in the Contract Documents.

2. Basis of Payment: Shall include but not limited to sawcut, excavation, including all utility trenching work as specified in Section 31 23 16 – Utility Trenching, water valve, valve box, riser, accessories, concrete collar, tests, backfill and surface restoration as required by the contract documents and as directed by the Engineer.
- Z. Bid Item No 33 – Water Line Tie In
1. Basis of Measurement: By Each as specified in the bid form complete in place, unless otherwise specified in the Contract Documents.
 2. Basis of Payment: Shall include but not limited to sawcut, excavation, all utility trenching work as specified in Section 31 23 16 – Utility Trenching, protecting the excavation in compliance with Cal/OSHA, pipe and fittings, bedding, backfill, surface restoration, AC patch, concrete thrust restraints, mechanical joints, warning tape tracer wire, tapping sleeve, tapping valves, and accessories to connect to the existing water main, pressure pipeline testing, flushing, disinfection and surface restoration as required by the contract documents and as directed by the Engineer.
- AA. Bid Item No 34 – Backflow Preventor
1. Basis of Measurement: By Each as specified in the bid form complete in place, unless otherwise specified in the Contract Documents.
 2. Basis of Payment: Shall include but not limited to sawcut, excavation, backflow assembly, accessories, test, and backfill and surface restoration complete in place as required by the contract documents and as directed by the Engineer.
 3. Includes City Staff inspection and Testing.
- BB. Bid Item No 35 – Bioretention Drain Rock
1. Basis of Measurement: By Cubic Yard as specified in the bid form complete in place, unless otherwise specified in the Contract Documents.
 2. Basis of Payment: Shall include but not limited to supplying and installation of Bioretention and Gravel Drain Rock materials, testing, stockpiling, maintaining, moving, placing, grading, and compaction complete in place as required by the contract documents and as directed by the Engineer.
- CC. Bid Item No 36 – Asphalt
1. Basis of Measurement: By Tons and will be based on certified weight-meters certificates showing gross, net weight and the type and grading of the mix for each load complete in place, unless otherwise specified in the Contract Documents.
 2. Basis of Payment: Shall include but not limited to priming surfaces, tack coating surfaces, fog seal, furnishing, placing, compacting asphalt pavement (3.5" for Full Depth Areas) complete in place as required by the contract documents and as directed by the Engineer.
- DD. Bid Item No 37 – Aggregate Base Course

1. Basis of Measurement: By the Tons as specified in the bid form. Quantities of aggregates will be calculated on the basis of dimensions shown on the plans. No allowance will be made for aggregate rejected or placed outside said dimensions unless otherwise order by the Engineer.
2. Aggregate Base used under concrete work such as curb and gutter, valley gutter, sidewalk, driveways, curb ramps, median curbs, median nose surfacing, bus turnouts, retaining curbs, and in utility trenches shall not be measured unless specified otherwise in the Contract Documents.
3. Basis of Payment: Shall include but not limited to full compensation for furnishing all labor, materials, tools, equipment and incidentals, in aggregate base supplying fill material, stockpiling, scarifying subgrade surface, placing where required, watering, dust palliative, leveling, compacting and certifying the top of aggregate base design grades complete in place as required by the contract documents and as directed by the Engineer.
4. Aggregate Base used under concrete work such as curb and gutter, valley gutter, sidewalk, retaining curbs, etc. shall considered incidental to the item most closely related to and no separate compensation will be allowed therefore. Aggregate base used in utility trenches shall be considered incidental to the cost per linear foot paid for the utility pipes as shown on the bid form and no separate compensation will be allowed therefore.

EE. Bid Item No 38 – Concrete Curb

1. Basis of Measurement: By Linear Feet as specified in the bid form complete in place, unless otherwise specified in the Contract Documents. Concrete pads around utility facilities and miscellaneous concrete footings are incidental to the bid item most closely related to and no separate compensation allowed therefor. Curb and gutter and vertical curbs adjacent to the curb ramp will be measured separately. Concrete Survey Monuments shall be measured on a per unit basis.
2. Basis of Payment: Shall include but not limited to all labor, materials, tools, equipment, and incidentals including subgrade preparation, excavation, base preparation, forms, reinforcing, concrete, accessories, placing concrete, finishing concrete, expansion joints, weakened plane joints, scoring joints, curing, removal of all forms, and testing complete in place as required by the contract documents and as directed by the Engineer.

FF. Bid Item No 39 - Pedestrian Concrete Paving A

1. Basis of Measurement: By Square Foot as specified in the bid form complete in place, unless otherwise specified in the Contract Documents.
2. Basis of Payment: Shall include but not limited to full compensation for furnishing full compensation for furnishing all labor, materials, tools, equipment, incidentals, excavation, subgrade preparation, aggregate base,

compaction testing, Portland cement mix, finishes, sand base, reinforcing steel, up to (3) 4' x 4' field mock-up panels of each paving type, and for doing all the work involved in installing Pedestrian Concrete Paving A, complete in place as required by the contract documents and as directed by the Engineer.

GG. Bid Item No 40– Landscape Wall

1. Basis of Measurement: By Linear Foot as specified in the bid form complete in place, unless otherwise specified in the Contract Documents.
2. Basis of Payment: Shall include but not limited to full compensation for full compensation for furnishing all labor, materials, tools, equipment, incidentals, Portland cement, integral color concrete, finishes, caulking, aggregate base, reinforcing steel, field mock-up wall, and for doing all the work involved in installing Landscape Wall, complete in place as required by the contract documents and as directed by the Engineer.

HH. Bid Item No 41– Curb Ramp

1. Basis of Measurement: By Each as specified in the bid form complete in place, unless otherwise specified in the Contract Documents. Truncated domes for curb ramps are not measured separately and are considered incidental to the pay item for Curb Ramps. Retaining curbs at curb ramps are not measured and are considered incidental to the measurement of curb ramps.
2. Basis of Payment: Includes all labor, materials, tools, equipment, and incidentals including subgrade preparation, excavation, base preparation, forms, reinforcing, concrete, accessories, placing concrete, finishing concrete, expansion joints, **installation of truncated domes**, weakened plane joints, scoring joints, curing, removal of all forms, and testing complete in place as required by the contract documents and as directed by the Engineer.

II. Bid Item No 42– Traffic Signage

1. Basis of Measurement: By Lump Sum as specified in the bid form complete in place, unless otherwise specified in the Contract Documents.
2. Basis of Payment: Shall include but not limited to full compensation for furnishing all labor, materials, tools, equipment, signage, post, footing, and incidentals, and for doing all work involved in installing Traffic Signage complete in place as required by the contract documents and as directed by the Engineer.

JJ. Bid Item No 43– Concrete Valley Gutter

1. Basis of Measurement: By Linear Foot as specified in the bid form complete in place, unless otherwise specified in the Contract Documents.

2. Basis of Payment: Shall include but not limited to all labor, materials, tools, equipment, and incidentals including subgrade preparation, excavation, base preparation, forms, reinforcing, concrete, accessories, placing concrete, finishing concrete, expansion joints, weakened plane joints, scoring joints, curing, removal of all forms, and testing as required by the contract documents and as directed by the Engineer.

KK. Bid Item No 44 – Wheel Stops

1. Basis of Measurement: By Each as specified in the bid form complete in place, unless otherwise specified in the Contract Documents.
2. Basis of Payment: Shall include but not limited to full compensation for furnishing all labor, materials, tools, equipment, and incidentals and for doing all the work involved in installing Wheel Stops as required by the contract documents and as directed by the Engineer.

LL. Bid Item No 45 – Striping Removal

1. Basis of Measurement: By Lump Sum as specified in the bid form complete in place, unless otherwise specified in the Contract Documents.
2. Basis of Payment: Shall include but not limited to full compensation for furnishing all labor, materials, tools, equipment, and incidentals, and for doing all work involved in Striping Removal, as shown on the plans, as specified and as directed by the Engineer, including the removal and disposal of all the resulting material.

MM. Bid Item No 46 – Striping

1. Basis of Measurement: By Lump Sum as specified in the bid form complete in place, unless otherwise specified in the Contract Documents.
2. Basis of Payment: Shall include but not limited to full compensation for furnishing all labor, materials, paint, template, tools, equipment, and incidentals, and for doing all work involved in Striping as required by the contract documents and as directed by the Engineer.

NN. Bid Item No 47 – Stairs & Handrail

1. Basis of Measurement: By Lump Sum as specified in the bid form complete in place, unless otherwise specified in the Contract Documents.
2. Basis of Payment: Shall include but not limited to full compensation for full compensation for furnishing all labor, materials, tools, equipment, incidentals, excavation, footings, metal fabrication, finishing, Portland cement, decomposed granite, binder, aggregate base, and for doing all the work involved in installing Stairs & Handrail, complete in place as required by the contract documents and as directed by the Engineer.

OO. Bid Item No 48 – Hydroseed

1. Basis of Measurement: By Square Foot as specified in the bid form complete in place, unless otherwise specified in the Contract Documents.

2. Basis of Payment: Shall include but not limited to full compensation for furnishing all labor, materials, tools, equipment, and incidentals, seed mix, binder, soil amendment, organic fertilizers, warranties, and for doing all the work involved in installing in installing Hydroseed, complete in place as required by the contract documents and as directed by the Engineer.

PP. Bid Item No 49 – Shrub -1 Gallon

1. Basis of Measurement: By Each as specified in the bid form complete in place, unless otherwise specified in the Contract Documents.
2. Basis of Payment: Shall include but not limited to full compensation for furnishing all labor, materials, tools, equipment, incidentals, 1-gallon shrubs, and warranties and for doing all the work involved in installing Shrub (1-Gallon), complete in place as required by the contract documents and as directed by the Engineer.

QQ. Bid Item No 50 – Sod

1. Basis of Measurement: By Square Foot as specified in the bid form complete in place, unless otherwise specified in the Contract Documents.
2. Basis of Payment: Shall include but not limited to full compensation for furnishing all labor, materials, tools, equipment, and incidentals, sod, post-planting fertilizers, warranties, and for doing all the work involved in installing in installing Sod, complete in place as required by the contract documents and as directed by the Engineer.

RR. Bid Item No 51 –Tree – 24” Box

Bid Item No 52 –Tree – 15 Gallon

1. Basis of Measurement: By Each as specified in the bid form complete in place, unless otherwise specified in the Contract Documents.
2. Basis of Payment: Shall include but not limited to full compensation for furnishing all labor, materials, tools, equipment, incidentals, excavation, tree stakes, tree ties, warranties, and for doing all the work involved in installing Tree (24” Box) and Tree (15 Gallon),, complete in place as required by the contract documents and as directed by the Engineer.

SS. Bid Item No 53 – Landscape Soil Preparation

1. Basis of Measurement: By Square Foot as specified in the bid form complete in place, unless otherwise specified in the Contract Documents.
2. Basis of Payment: Shall include but not limited to full compensation for furnishing all labor, materials, tools, equipment, and incidentals, soil testing report, soil amendment with organic compost, import topsoil, organic fertilizers, warranties, and for doing all the work involved in installing in Landscape Soil Preparation, complete in place as required by the contract documents and as directed by the Engineer.

TT. Bid Item No 54 – Root Barrier

1. Basis of Measurement: By Linear Foot as specified in the bid form complete in place, unless otherwise specified in the Contract Documents.
2. Basis of Payment: Shall include but not limited to full compensation for furnishing all labor, materials, tools, equipment, incidentals, root barrier, and warranties and for doing all the work involved in installing Root Barrier, complete in place as required by the contract documents and as directed by the Engineer.

UU. Bid Item No 55 – Mulch

1. Basis of Measurement: By Square Foot as specified in the bid form complete in place, unless otherwise specified in the Contract Documents.
2. Basis of Payment: Shall include but not limited to full compensation for furnishing all labor, materials, tools, equipment, incidentals, mulch, and for doing all the work involved in installing Mulch, complete in place as required by the contract documents and as directed by the Engineer.

VV. Bid Item No 56 – Plant Establishment Period

1. Basis of Measurement: By Square Foot as specified in the bid form complete in place, unless otherwise specified in the Contract Documents.
2. Basis of Payment: Shall include but not limited to full compensation for furnishing all labor, materials, tools, equipment, incidentals, repairs, soils testing, irrigation adjustments, additional bark mulch, fertilizers, weed control, mowing, rodent control, and for doing all the work involved in Plant Establishment Period (90 days) complete in place as required by the contract documents and as directed by the Engineer.

WW. Bid Item No 57 – Irrigation Controller

1. Basis of Measurement: By Each as specified in the bid form complete in place, unless otherwise specified in the Contract Documents.
2. Basis of Payment: Shall include but not limited to full compensation for furnishing all labor, materials, tools, equipment, incidentals, warranties, rain sensor, cellular network card, irrigation controller, and for doing all the work involved in installing Irrigation Controller complete in place as required by the contract documents and as directed by the Engineer.

XX. Bid Item No 58 – Irrigation Rotors

1. Basis of Measurement: By Each as specified in the bid form complete in place, unless otherwise specified in the Contract Documents.
2. Basis of Payment: Shall include but not limited to full compensation for furnishing all labor, materials, tools, equipment, incidentals, adjustments, , trenching, backfill, warranties, and for doing all the work involved in installing Irrigation Rotors complete in place as required by the contract documents and as directed by the Engineer.

YY. Bid Item No. 59 – Irrigation (Bubblers)

1. Basis of Measurement: By Each as specified in the bid form complete in place, unless otherwise specified in the Contract Documents.
2. Basis of Payment: Shall include but not limited to full compensation for furnishing all labor, materials, tools, equipment, incidentals, adjustments, , trenching, backfill, warranties, and for doing all the work involved in installing Irrigation (Bubblers) complete in place as required by the contract documents and as directed by the Engineer.

ZZ. Bid Item No 60 – Flush valve

1. Basis of Measurement: By Each as specified in the bid form complete in place, unless otherwise specified in the Contract Documents.
2. Basis of Payment: Shall include but not limited to full compensation for furnishing all labor, materials, tools, equipment, incidentals, warranties, irrigation air relief valve assembly, connection to air relief valve, and for doing all the work involved in installing Irrigation Air Relief Valve Assembly complete in place as required by the contract documents and as directed by the Engineer.

AAA. Bid Item No 61 – Irrigation Tree Bubblers

1. Basis of Measurement: By Each as specified in the bid form complete in place, unless otherwise specified in the Contract Documents.
2. Basis of Payment: Shall include but not limited to full compensation for furnishing all labor, materials, tools, equipment, incidentals, warranties, tree bubblers, and for doing all the work involved in installing Irrigation Tree Bubbler complete in place as required by the contract documents and as directed by the Engineer.

BBB. Bid Item No 62– Irrigation Lateral Line

1. Basis of Measurement: By Linear Foot as specified in the bid form complete in place, unless otherwise specified in the Contract Documents.
2. Basis of Payment: Shall include but not limited to full compensation for furnishing all labor, materials, tools, equipment, incidentals, warranties, conduits, trenching, bedding, fittings, fill and compaction, and for doing all the work involved in installing Irrigation Lateral Line complete in place as required by the contract documents and as directed by the Engineer.

CCC. Bid Item No 63– Irrigation Conduit

1. Basis of Measurement: By Linear Foot as specified in the bid form complete in place, unless otherwise specified in the Contract Documents.
2. Basis of Payment: Shall include but not limited to full compensation for furnishing all labor, materials, tools, equipment, incidentals, warranties, conduits, and for doing all the work involved in installing Irrigation Conduit complete in place as required by the contract documents and as directed by the Engineer.

DDD. Bid Item No 64 – Irrigation Gate Valves

1. Basis of Measurement: By Each as specified in the bid form complete in place, unless otherwise specified in the Contract Documents.
2. Basis of Payment: Shall include but not limited to full compensation for furnishing all labor, materials, tools, equipment, incidentals, warranties, irrigation gate valve assembly, valve box, drain rocks, wire mesh, PVC pipe, connection to gate valve, and for doing all the work involved in installing Irrigation Gate Valve complete in place as required by the contract documents and as directed by the Engineer.

EEE. Bid Item No 65– Irrigation Drip

1. Basis of Measurement: By Square Foot as specified in the bid form complete in place, unless otherwise specified in the Contract Documents.
2. Basis of Payment: Shall include but not limited to full compensation for furnishing all labor, materials, tools, equipment, incidentals, warranties, schedule 40 PVC pipe, schedule 40 tee, fittings, dripline, operation indicator, flush valve, tubing, and for doing all the work involved in installing Irrigation Drip complete in place as required by the contract documents and as directed by the Engineer.

FFF. Bid Item No 66 – Irrigation Sleeves

1. Basis of Measurement: By Linear Foot as specified in the bid form complete in place, unless otherwise specified in the Contract Documents.
2. Basis of Payment: Shall include but not limited to full compensation for furnishing all labor, materials, tools, equipment, incidentals, warranties, excavation, 4" dia. and 8" dia. sleeves, backfill, air release valve, and for doing all the work involved in installing Irrigation Sleeves (4", 8", and 10") complete in place as required by the contract documents and as directed by the Engineer.

GGG. Bid Item No 67 – Irrigation Main line 2"-3"

Bid Item No 68 – Irrigation Main line 4" & 6"

1. Basis of Measurement: By Linear Foot as specified in the bid form complete in place, unless otherwise specified in the Contract Documents.
2. Basis of Payment: Shall include but not limited to full compensation for furnishing all labor, materials, tools, equipment, incidentals, warranties, excavation, 1120-200 psi PVC pipe, air release valve, with ductile iron fittings, concrete thrust blocks, Class 315 PVC pipe with schedule 80 PVC solvent weld fittings, backfill, and for doing all the work involved in installing & testing Irrigation Main Line (2"-3", 4" & 6") complete in place as required by the contract documents and as directed by the Engineer.

HHH. Bid Item No 69 – Irrigation Master Valve and Flow Sensor

1. Basis of Measurement: By Each as specified in the bid form complete in place, unless otherwise specified in the Contract Documents.
2. Basis of Payment: Shall include but not limited to full compensation for furnishing all labor, materials, tools, equipment, incidentals, warranties, flow sensor cable & master valve wires, 4" PVC conduit and low voltage wires extended to new controller and for doing all the work involved in installing Master Valve and Flow Sensor complete in place as required by the contract documents and as directed by the Engineer.

III. Bid Item No 70 – Irrigation Low Voltage Wire

1. Basis of Measurement: By Lump Sum as specified in the bid form complete in place, unless otherwise specified in the Contract Documents.
2. Basis of Payment: Shall include but not limited to full compensation for furnishing all labor, materials, tools, equipment, incidentals, warranties, and for doing all the work involved in installing Irrigation Low Voltage Wire complete in place as required by the contract documents and as directed by the Engineer.

JJJ. Bid Item No 71 – Irrigation Quick Coupler Valves

Bid Item No 72 – Irrigation Remote Control Valves

Bid Item No 73 – Irrigation Angle Valves

1. Basis of Measurement: By Each as specified in the bid form complete in place, unless otherwise specified in the Contract Documents.
2. Basis of Payment: Shall include but not limited to full compensation for furnishing all labor, materials, tools, equipment, incidentals, warranties, irrigation quick coupler and remote control valve assembly, valve box, drain rocks, wire mesh, PVC pipe, connection to gate valve, and for doing all the work involved in installing Irrigation Quick Coupler Valves and Irrigation Remote Control Valves complete in place as required by the contract documents and as directed by the Engineer.

KKK. Bid Item No 74 – Irrigation Restoration

1. Basis of Measurement: By Lump Sum as specified in the bid form complete in place, unless otherwise specified in the Contract Documents.
2. Basis of Payment: Shall include but not limited to full compensation for furnishing all labor, materials, tools, equipment, air release valve, incidentals, warranties to remove, or replace all aspects of the irrigation system, mainline, lateral lines, spray heads, rotors, sleeves, valve boxes, wires, conduits, trenching, backfill which is damaged during and, or impacted by construction, and for doing all the work involved in installing Irrigation Restoration complete in place as required by the contract documents and as directed by the Engineer.

LLL. Bid Item No 75 – Boulders

1. Basis of Measurement: By Each as specified in the bid form complete in place, unless otherwise specified in the Contract Documents.
2. Basis of Payment: Shall include but not limited to full compensation for furnishing all labor, materials, tools, equipment, boulder, excavation, coordination of delivery incidentals, warranties, and for doing all the work involved in installing Boulder complete in place as required by the contract documents and as directed by the Engineer.

MMM. Bid Item No 76 – Fence A (6')

Bid Item No 77 – Fence B (8')

1. Basis of Measurement: By Linear Foot as specified in the bid form complete in place, unless otherwise specified in the Contract Documents.
2. Basis of Payment: Shall include but not limited to full compensation for furnishing all labor, materials, tools, equipment, shop drawings, chain link fence posts of various height, chain link fabric, anchors, accessories, excavation, concrete footings, incidentals, warranties, and for doing all the work involved in installing Fence A (6'), and Fence B (8') complete in place as required by the contract documents and as directed by the Engineer.

NNN. Bid Item No 78– Gate A

Bid Item No 79 – Gate B

Bid Item No 80 – Gate C

1. Basis of Measurement: By Each as specified in the bid form complete in place, unless otherwise specified in the Contract Documents.
2. Basis of Payment: Shall include but not limited to full compensation for furnishing all labor, materials, tools, equipment, shop drawings, steel members, steel posts, finishing, hardware, accessories, reflective tape, excavation, receiver posts, Knox boxes, concrete footings, incidentals, warranties, and for doing all the work involved in installing Gate A, Gate B, and Gate C, complete in place as required by the contract documents and as directed by the Engineer.

OOO. Bid Item No 81 – Header

1. Basis of Measurement: By Linear Foot as specified in the bid form complete in place, unless otherwise specified in the Contract Documents.
2. Basis of Payment: Shall include but not limited to full compensation for furnishing all labor, materials, tools, equipment, header, stakes, accessories, incidentals, and for doing all the work involved in installing Header complete in place as required by the contract documents and as directed by the Engineer.

PPP. Bid Item No 82 – Soccer Goals

1. Basis of Measurement: By Each as specified in the bid form complete in place, unless otherwise specified in the Contract Documents.

2. Basis of Payment: Shall include but not limited to full compensation for furnishing all labor, materials, tools, equipment, soccer goal, hardware, wheels, net, handle, coordination of delivery, incidentals, warranties, and for doing all the work involved in installing Soccer Goals complete in place as required by the contract documents and as directed by the Engineer.

QQQ. Bid Item No 83 – Park Sign

1. Basis of Measurement: By Each as specified in the bid form complete in place, unless otherwise specified in the Contract Documents.
2. Basis of Payment: Shall include but not limited to full compensation for furnishing all labor, materials, tools, equipment, shop drawings, sign, stone veneered base, letters, City logo, accessories, excavation, concrete footing, reinforcing, incidentals, warranties, and for doing all the work involved in installing Park Sign complete in place as required by the contract documents and as directed by the Engineer.

RRR. Bid Item No 84 – Relocated Park Sign

1. Basis of Measurement: By Each as specified in the bid form complete in place, unless otherwise specified in the Contract Documents.
2. Basis of Payment: Shall include but not limited to full compensation for furnishing all labor, materials, tools, equipment, excavation, concrete footing, reinforcement, incidentals, and for doing all the work involved in installing Relocated Park Sign complete in place as required by the contract documents and as directed by the Engineer.

SSS. Bid Item No 85 – Site/Area Post top Luminaire

1. Basis of Measurement: By Each as specified in the bid form complete in place, unless otherwise specified in the Contract Documents.
2. Basis of Payment: Shall include but not limited to full compensation for furnishing all labor, materials, tools, equipment, connection, pole, light fixture, concrete base, reinforcement, gravel dry well, pull box, expertise and incidentals, warranties, and for doing all the work involved in installing Site/Area Post Top Luminaire complete in place as required by the contract documents and as directed by the Engineer.

TTT. Bid Item No 86 – Lighting Control System

1. Basis of Measurement: By Lump Sum as specified in the bid form complete in place, unless otherwise specified in the Contract Documents.
2. Basis of Payment: Shall include but not limited to full compensation for furnishing all labor, materials, tools, equipment, lighting control panel, connection, expertise and incidentals, warranties, acceptance testing, and for doing all the work involved in installing Lighting Control System (non-sports lighting) complete in place as required by the contract documents and as directed by the Engineer.

UUU. Bid Item No 87 – Electrical Main Switchboard

1. Basis of Measurement: By Lump Sum as specified in the bid form complete in place, unless otherwise specified in the Contract Documents.
2. Basis of Payment: Shall include but not limited to full compensation for furnishing all labor, materials, tools, equipment, concrete pad, subgrade preparation, wiring, connections, expertise and incidentals, testing, warranties, and for doing all the work involved in installing Electrical Main Switchboard complete in place as directed by the Engineer.

VVV. Bid Item No 88– Distribution Power

1. Basis of Measurement: By Lump Sum as specified in the bid form complete in place, unless otherwise specified in the Contract Documents.
2. Basis of Payment: Shall include but not limited to full compensation for furnishing all labor, materials, tools, equipment, panels, connections, concrete pad, supports, subgrade preparation, anchors, bracing, fittings, supports, reinforcement, wiring, expertise and incidentals, testing, warranties, and for doing all the work involved in installing the Distribution Power complete in place as required by the contract documents and as directed by the Engineer

WWW. Bid Item No 89 – Transformers

1. Basis of Measurement: By Lump Sum as specified in the bid form complete in place, unless otherwise specified in the Contract Documents.
2. Basis of Payment: Shall include but not limited to full compensation for furnishing all labor, materials, tools, equipment, concrete pad or supports, subgrade preparation, connection, expertise and incidentals, warranties, and for doing all the work involved in installing Transformer complete in place as required by the contract documents and as directed by the Engineer.

XXX. Bid Item No 90 – Conduit and Conductors (Electrical and Lighting)

1. Basis of Measurement: By Lump Sum as specified in the bid form complete in place, unless otherwise specified in the Contract Documents.
2. Basis of Payment: Shall include but not limited to full compensation for furnishing all labor, materials, tools, equipment, expertise and incidentals, warranties, and for doing all the work involved in installing Conduit and Conductors complete in place as required by the contract documents and as directed by the Engineer.

YYY. Bid Item No 91 – Conduit (Technology, 2-inch, 4-inch)

1. Basis of Measurement: By Linear Foot as specified in the bid form complete in place, unless otherwise specified in the Contract Documents.
2. Basis of Payment: Shall include but not limited to full compensation for furnishing all labor, materials, tools, equipment, expertise and incidentals, warranties, and for doing all the work involved in installing Conduit

(Technology, 2-inch, 4-inch) complete in place as required by the contract documents and as directed by the Engineer.

ZZZ. Bid Item No 92 – Handholes (Pullbox)

1. Basis of Measurement: By Each as specified in the bid form complete in place, unless otherwise specified in the Contract Documents.
2. Basis of Payment: Shall include but not limited to full compensation for furnishing all labor, materials, tools, equipment, expertise and incidentals, warranties, and for doing all the work involved in installing Handholes complete in place as required by the contract documents and as directed by the Engineer.

AAAA. Bid Item No 93 – Underground Vaults

1. Basis of Measurement: By Lump Sum as specified in the bid form complete in place, unless otherwise specified in the Contract Documents.
2. Basis of Payment: Shall include but not limited to full compensation for furnishing all labor, materials, tools, equipment, expertise and incidentals, warranties, and for doing all the work involved in installing Underground Vaults complete in place as required by the contract documents and as directed by the Engineer.

BBBB. Bid Item No 94 - Fill Slope, Keyway and Subdrain

1. Basis of Measurement: By Lump Sum as specified in the bid form complete in place, unless otherwise specified in the Contract Documents.
2. Basis of Payment: This shall include but not be limited to the lump sum cost Fill Slope, Keyway, 6" Storm Drain Pipe, 4" Perforated Subdrain, and cleanout as shown on sheet C4.3 within the dash limits and Detail 4/ C5.4. This shall include all related labor, work, materials, engineered fill, earthwork, benching, compaction, hydroseed, and temporary irrigation for the southern cut fill slope as specified by the contract documents and as directed by the Engineer. Site conditions shall be reviewed in the field during Earthwork excavation with the Engineer to determine the direction of the bed rock bedding plane and to determine if keyway and subdrain shall be implemented.

END OF SECTION 01 22 00

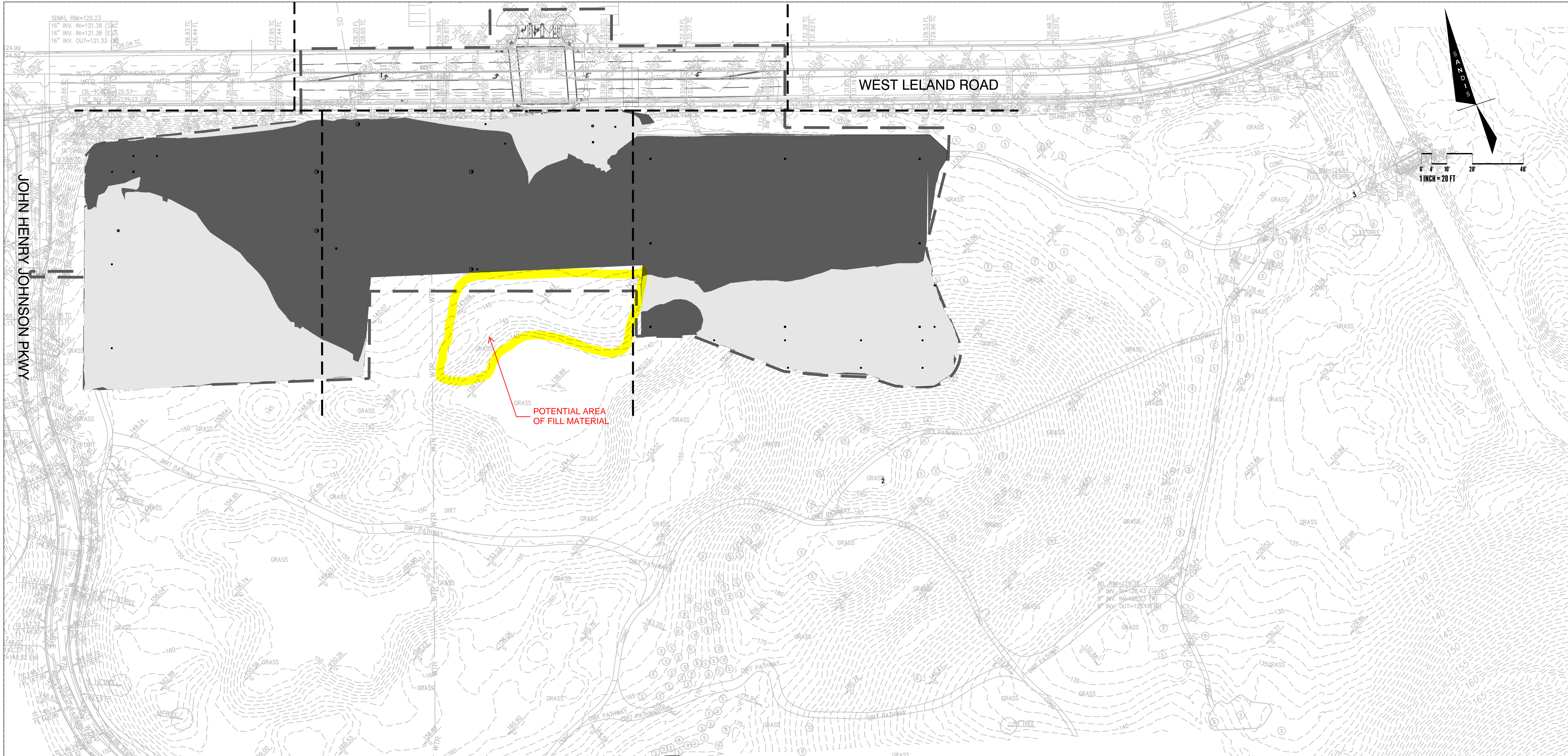

REGISTERED PROFESSIONAL ENGINEER
 CHAD J. BROWNING
 No. C68315
 Exp. 9/30/25
 CIVIL
 STATE OF CALIFORNIA

PREPARED UNDER THE DIRECTION OF:

 CHAD J. BROWNING
 P.C.E. NO. 66315
 EXPIRES 9-30-25

ACCEPTED FOR USE:
 JOHN SAMUELSON
 City Engineer
 Date: _____

City of Pittsburg

**PITTSBURG PREMIER FIELDS
 CUT AND FILL PLAN**

LEGEND

- CUT AREAS
- FILL AREAS

NOTES

1. PER GEOTECHNICAL REPORT, ALL CUT AREAS SHOULD BE OVEREXCAVATED A MINIMUM OF 3' BELOW FINISHED SUBGRADE ELEVATION WITHIN THE SPORTS FIELD, EXTERIOR FLATWORK, PAVERS, AND PAVEMENTS AND A MINIMUM OF 5' BELOW FOUNDATIONS. THE OVEREXCAVATION SHOULD EXTEND A MINIMUM OF 5' Laterally BEYOND THE CUT LIMITS WHERE FEASIBLE. THIS NOTE DOES NOT APPLY TO THE PLANNED CUT SLOPE

KEY MAP

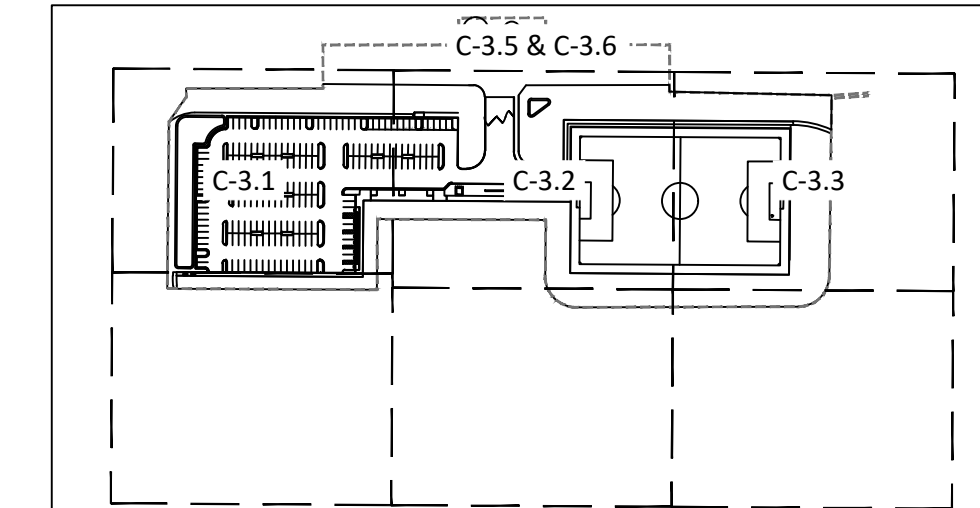

DATE	REV	DESCRIPTION	BY	DRAWN:LS	CHECKED:SC	REVIEWED:DL	DATE: 10/07/24	SCALE: AS NOTE

SHEET NO.
14 OF 82

DWG. NO.
C-3.4